



AMELIA



AMELIA Model number: 52NXT28684AH19

4 beds • 2 baths • 1904 sq.ft. • 28' width • 68' depth

Our home building facilities invest in continuous product and process improvements. Plans, dimensions, features, materials, specifications and availability are subject to change without notice or obligation. Renderings and floor plans are representative likenesses of our homes and may differ from the actual homes. We invite you to tour a Home Center near you and inspect the highest value in quality housing available or call (337) 369-3588 to speak with a Home Consultant. Copyright 2017, CMH. All rights reserved.

<https://www.claytonhomesnewiberia.com>

**CLAYTON HOMES-NEW
IBERIA**

**8304 WEST HWY 90
NEW IBERIA, LA 70560**

**Monday - Thursday: 9am to 6pm
Friday: 9am to 6pm
Saturday: 9am to 5pm
Sunday: Closed**

(337) 369-3588

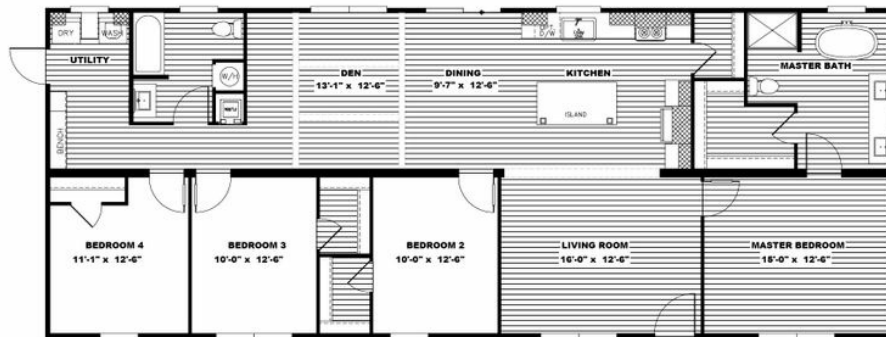

AMELIA Model number: 52NXT28684AH19

4 beds • 2 baths • 1904 sq.ft. • 28' width • 68' depth

Our home building facilities invest in continuous product and process improvements. Plans, dimensions, features, materials, specifications and availability are subject to change without notice or obligation. Renderings and floor plans are representative likenesses of our homes and may differ from the actual homes. We invite you to tour a Home Center near you and inspect the highest value in quality housing available or call (337) 369-3588 to speak with a Home Consultant. Copyright 2017, CMH. All rights reserved.

<https://www.claytonhomesnewiberia.com>

CLAYTON HOMES-NEW IBERIA

8304 WEST HWY 90
NEW IBERIA, LA 70560

Monday - Thursday: 9am to 6pm
Friday: 9am to 6pm
Saturday: 9am to 5pm
Sunday: Closed

(337) 369-3588